

Top View

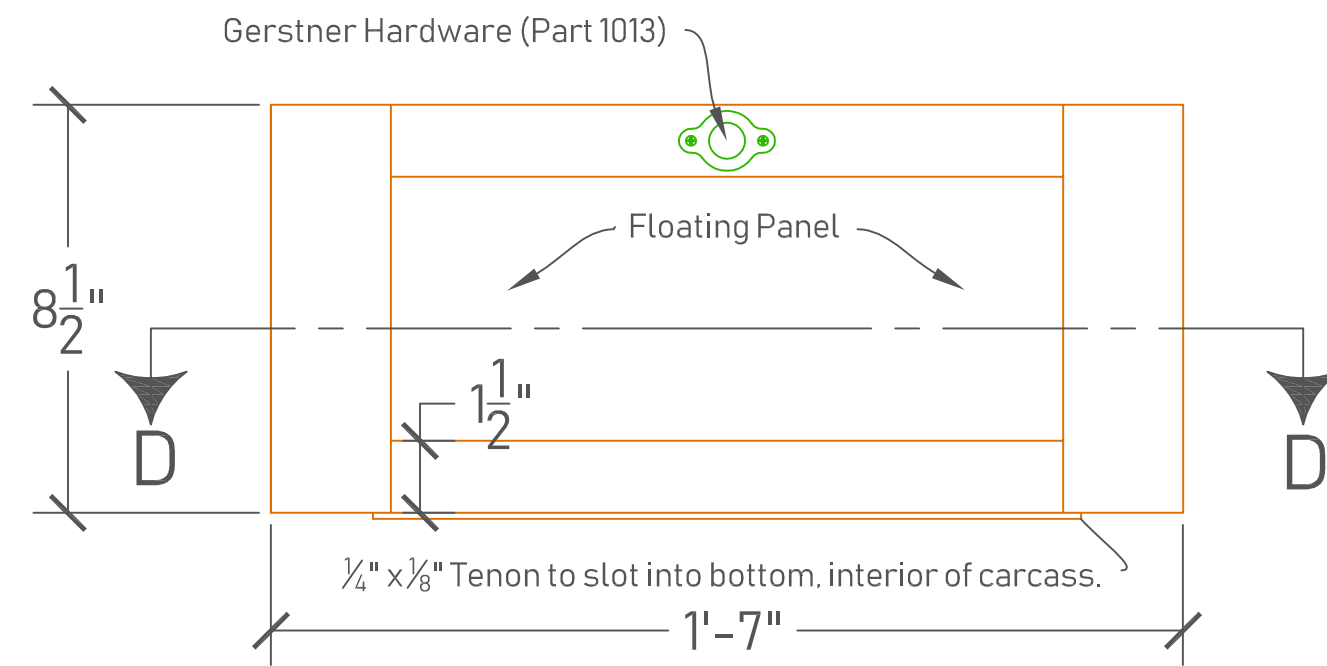

Front Panel Detail

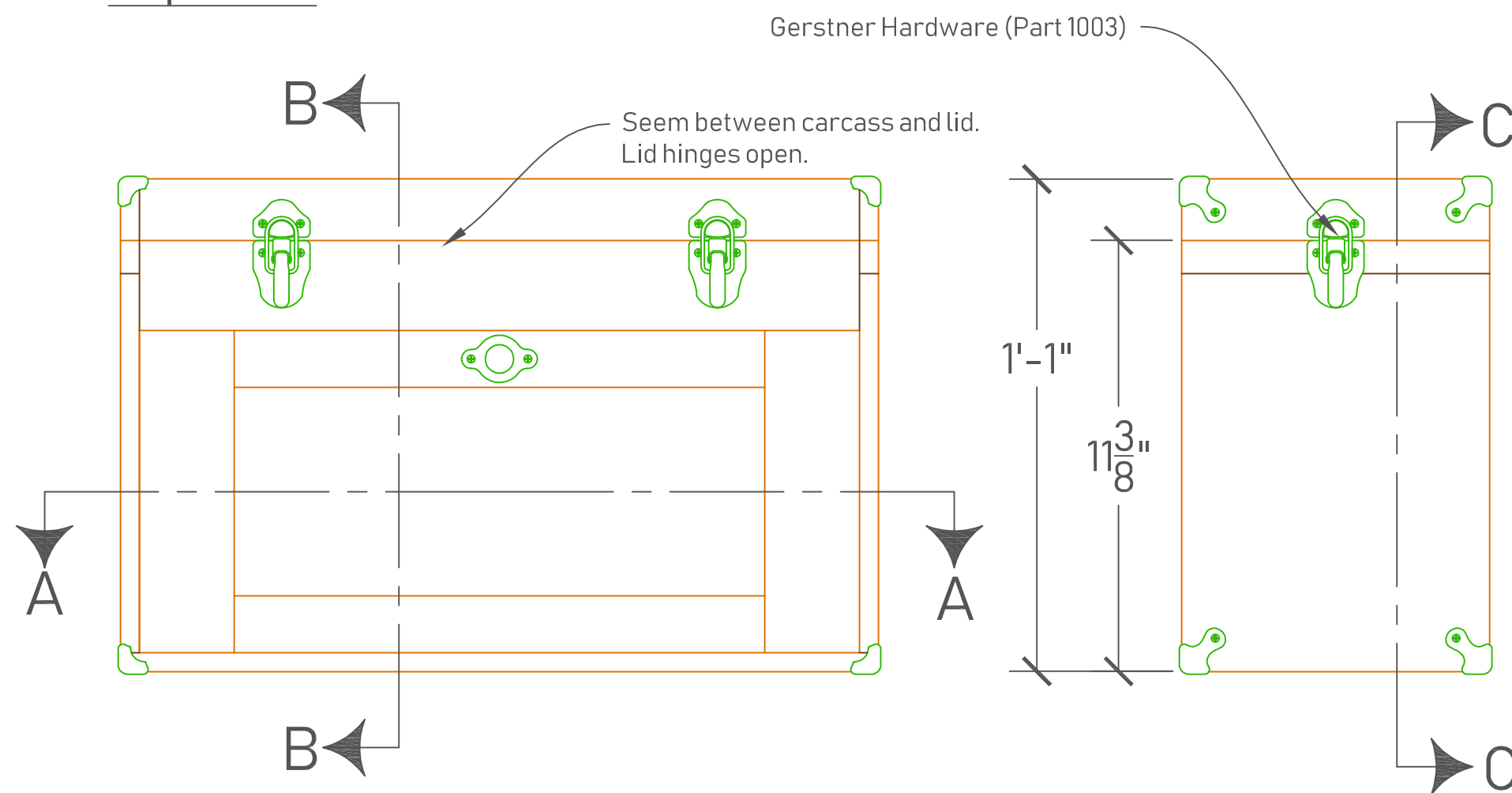

Front View

Side View

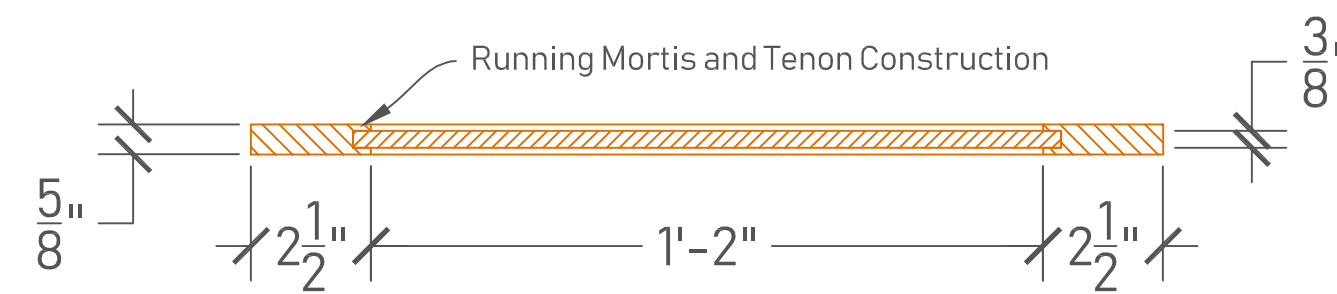

Section D

Notes:

- Carcass and drawer fronts are made from 1/2" thick Red Oak. Drawer sides are poplar.
- Front Panel can be removed and stored under bottom drawer.
- Front Panel is secured with two, spring-action bolts that are secured when lid is shut.
- Finish with Osmo Polyx.

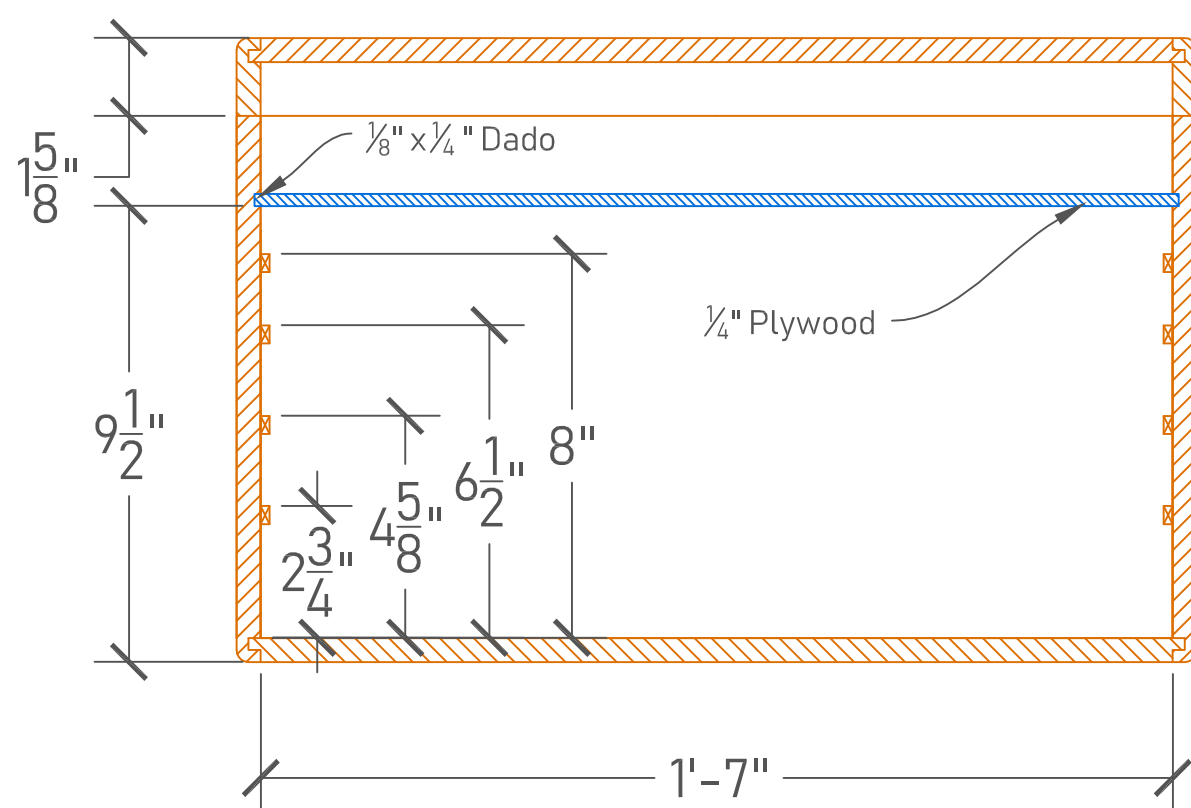

Section C

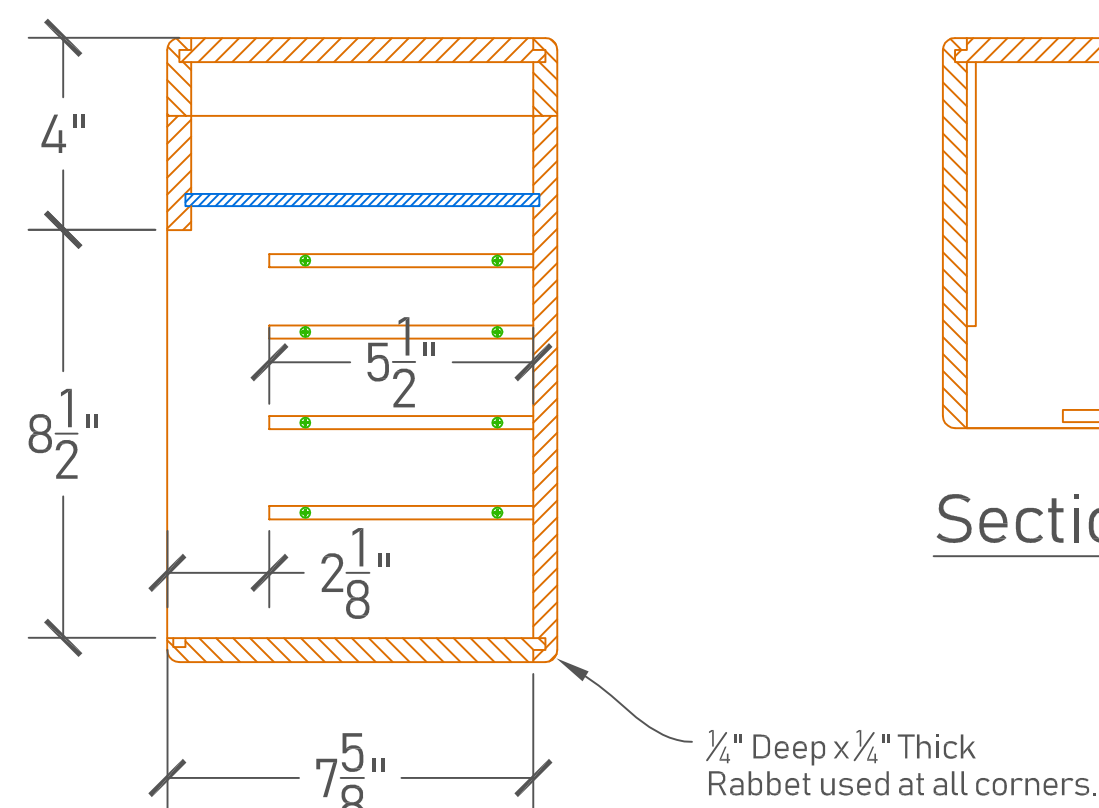

Section B

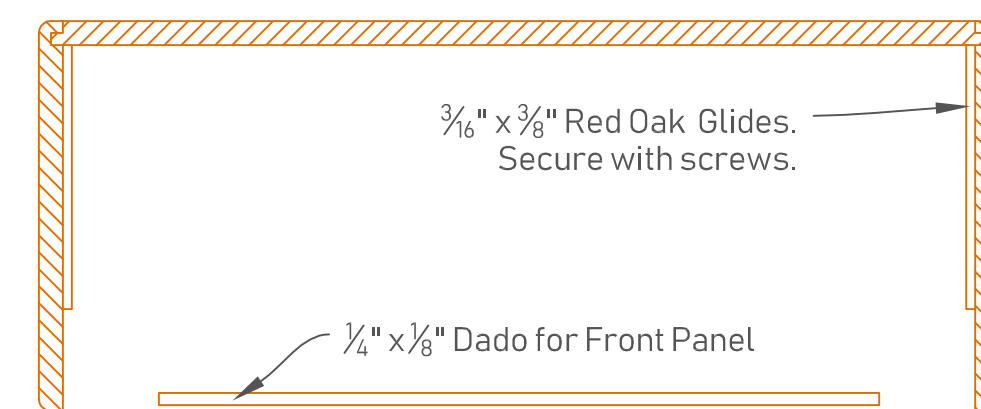

Section A

Machinist Tool Box- Carcass

Scale: 3" = 1'-0"

Drawn By: Lisa Griebel

Drawing 1 of 2

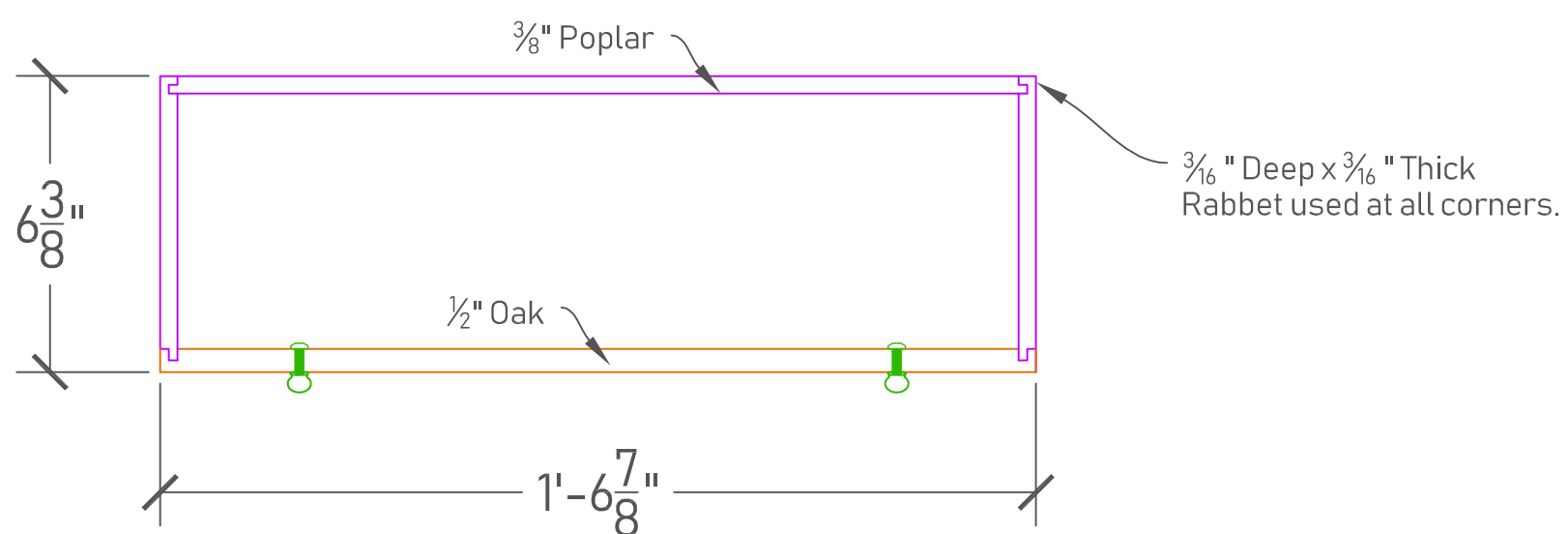

Plan View

- Applicable for all three sizes of drawers.
- Build four drawers in total.

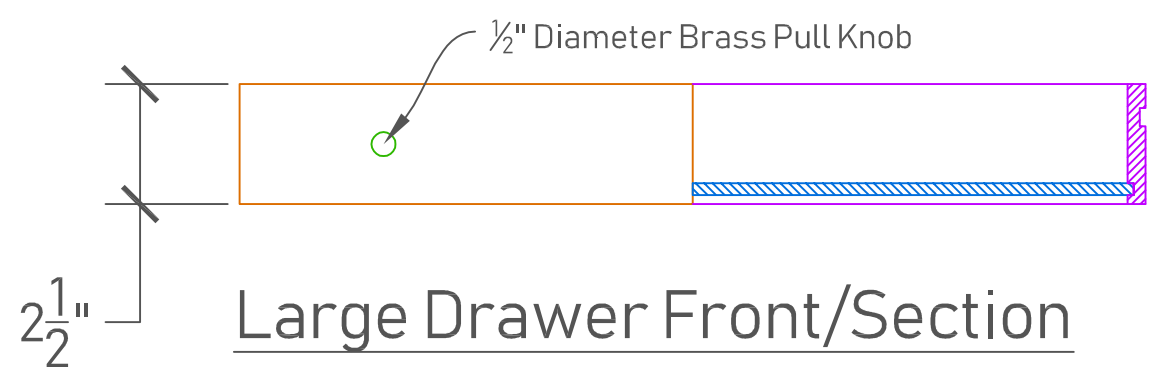

Large Drawer Front/Section  
- Build One

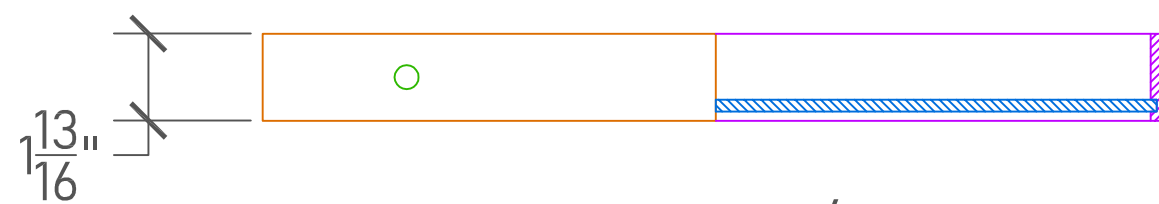

Med. Drawer Front/Section  
- Build Two



Small Drawer Front/Section  
- Build One

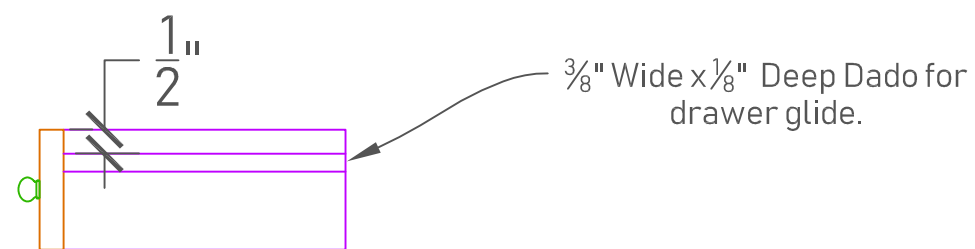

Large Drawer Side

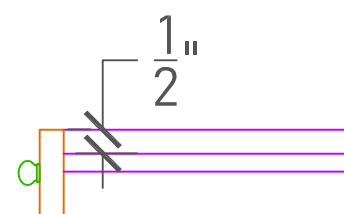

Med. Drawer Side

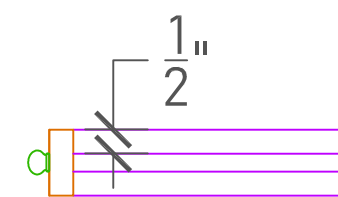

Small Drawer Side

Notes:

- Drawer fronts are made from 1/2" thick Red Oak. Drawer sides are 3/8" poplar.
- All drawers have a 3/8" wide x 1/8" deep dado running 1/2" from top to accept glide mounted on interior of carcass.
- Bottom of all drawers and main, top compartment will have green felt applied with hide glue.
- Finish with Osmo Polyx.

Machinist Tool Box- Drawers  
Scale: 3" = 1'-0"  
Drawn By: Lisa Griebel  
Drawing 2 of 2